

LUGGAGE COMPARTMENT LOCKS

To suit 1235 mm door width.
For details on 2477/001, end slams see d16.

	A	B	C	D	E	F	G	H
0881 & 0883	For Part Numbers see below							
METRIC (mm)	140	89	20	20	20	110		
IMPERIAL (ins)	5.51	3.5	0.8	0.8	0.8	4.33		
0883/010	Luggage lock c/w rods and 2 slams							
	Zinc plated lock (locking) with 2477 slams							
0883/510	Luggage lock c/w rods and 2 slams							
	Black & Stainless lock (locking) with 2477 slams							
0881/510	Centre lock only. Black and stainless (locking)							

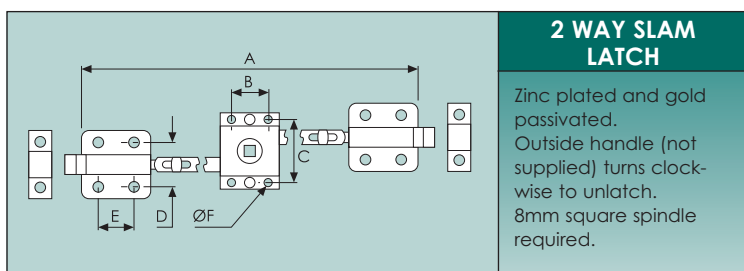

2 WAY SLAM LATCH

Zinc plated and gold passivated.
Outside handle (not supplied) turns clockwise to unlatch.
8mm square spindle required.

	A	B	C	D	E	F	G	H
5589/180								
METRIC (mm)	1440	38.1	57.2	44.5	33	3.8		
IMPERIAL (ins)	56.7	1.5	2.25	1.75	1.3	0.15		

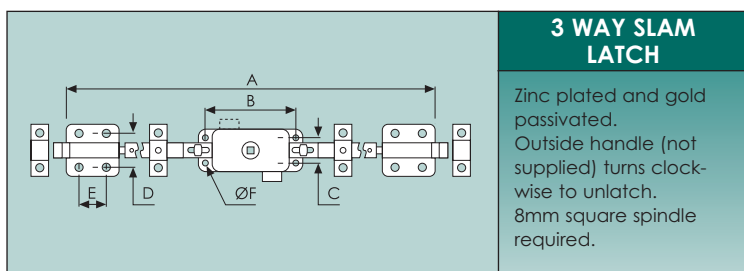

3 WAY SLAM LATCH

Zinc plated and gold passivated.
Outside handle (not supplied) turns clockwise to unlatch.
8mm square spindle required.

	A	B	C	D	E	F	G	H
5589/212								
METRIC (mm)	2057	114.3	28.5	44.5	33	5		
IMPERIAL (ins)	81	4.5	1.12	1.75	1.3	0.2		

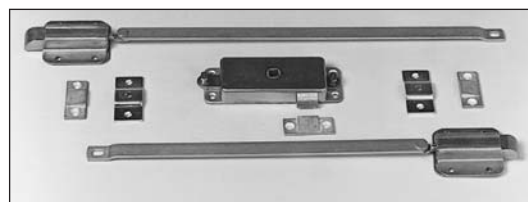

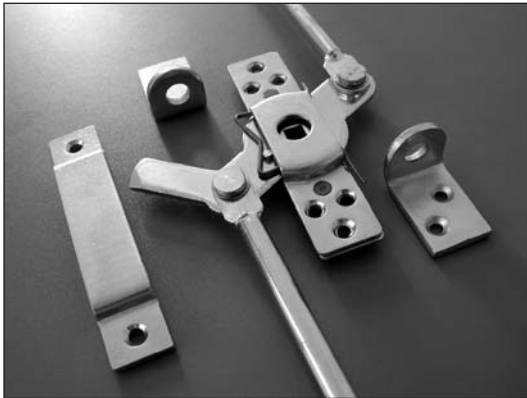

ROD LOCKS									
Zinc plated. Supplied with 2 x 1135mm rods, & guides. NB Rod dimension from tip to tip in locked position is 2.31m (7'7") with a throw of 35mm (1.37"). 0770/011 keeper required (see below).									
	A	B	C	D	E	F	G	H	
0770/001	Type A (shown)				Weight 1.6kg/3.5lb				
0770/002	Type B								
METRIC (mm)	76.2	118	26.0	26.0	40.0	8.00	9.50	5.00	
IMPERIAL (ins)	3.00	4.65	1.02	1.02	1.58	0.32	0.37	0.20	
3 WAY WITH TONGUE									
0771/001	Type A (shown)				Weight 1.5kg/3.3lb				
0771/002	Type B								
METRIC (mm)	76.2	118	26.0	26.0	40.0	8.00	9.50	5.00	
IMPERIAL (ins)	3.00	4.65	1.02	1.02	1.58	0.32	0.37	0.20	
2 WAY NO TONGUE									

KEEPER									
Zinc plated. To fit 0770 rod locks.									
	A	B	C	D	E	F	G	H	
0770/011	Weight 100g/3.5oz								
METRIC (mm)	121	22.5	81.0	10.0	5.00	101			
IMPERIAL (ins)	4.76	0.89	3.20	0.40	0.20	3.98			

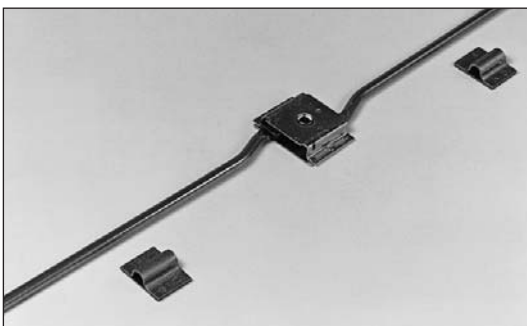

2 WAY ROD LOCK									
Zinc plated and gold passivated. Supplied with Ø9.5 mm bars with a total length of 1092 mm. 24 mm max. throw.									
	A	B	C	D	E	F	G	H	
5589/216	Right hand								
5589/218	Left hand (shown)								
METRIC (mm)	2210	38.1	57.2	22.1	25.4	4.32			
IMPERIAL (ins)	87.0	1.50	2.25	0.87	1.00	0.17			

		A	B	C	D	E	F	G	H
2298/002		Weight 1.21kg/2.7lb							
METRIC (mm)		37	121	63	45	105	9.5	5	
IMPERIAL (ins)		1.46	4.76	2.48	1.77	4.13	0.38	0.2	

ROD LOCK (2 WAY)

Self colour steel. Supplied with 2 x 914mm (3') rods. NB. Rod dimension from tip to tip in locked position is 1.85m (6'1") with a throw of 19mm (0.75"). 8mm square spindle required.

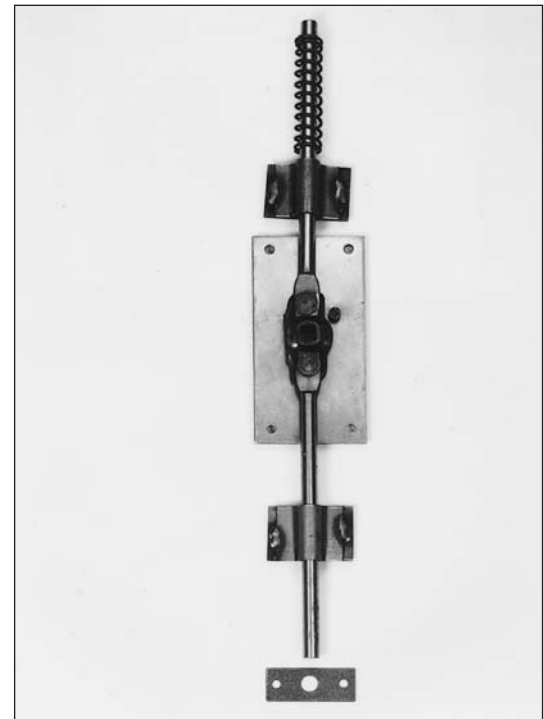
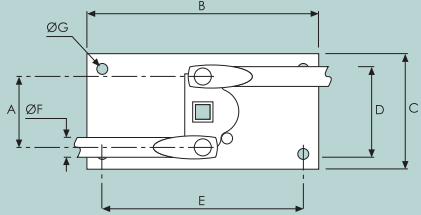

		A	B	C	D	E	F	G	H
2298/003		Weight 50g/1.8oz							
METRIC (mm)		40	32	10	13	2	2		
IMPERIAL (ins)		1.58	1.26	0.4	0.51	0.08	0.08		

ROD GUIDE

Self colour steel.

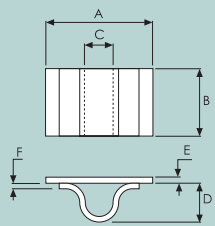

		A	B	C	D	E	F	G	H
2298/004		Weight 10g/0.4oz							
METRIC (mm)		68	16	1.5	13				
IMPERIAL (ins)		2.68	0.63	0.06	0.51				

ROD SPRING

Self colour steel.

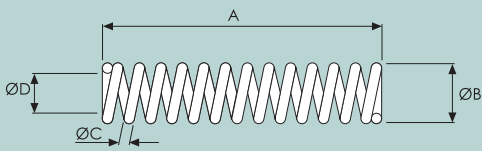

		A	B	C	D	E	F	G	H
2298/006		Weight 10g/0.4oz							
METRIC (mm)		50	19	38	1.5	9.5	4		
IMPERIAL (ins)		1.97	0.75	1.5	0.06	0.38	0.16		

BOTTOM SOCKET

Self colour steel.

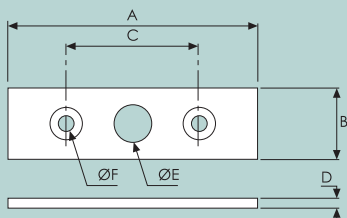

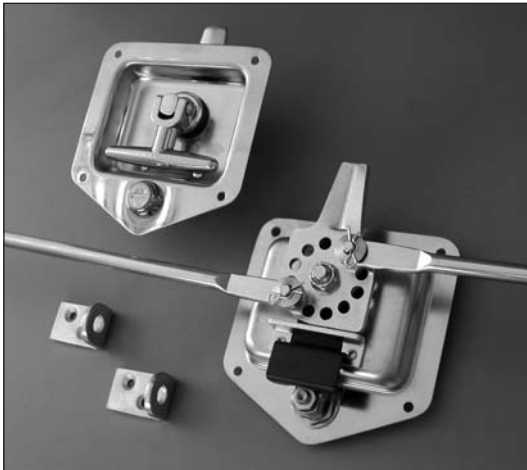

		RECESSED DROP 'T' ROD LOCK							
		Polished 304 stainless steel dish with a chrome plated die-cast 'T'. Zinc plated steel tongue. Complete with EPDM gasket. Supplied with 2 rods (1150mm long) & 2 rod guides. 2328mm tip/tip (closed). For recessed drop T handle only refer to page d37							
		A	B	C	D	E	F	G	H
0864/1000	2 point locking	Weight 700g/1.5lb							
		Universal, keyed alike							
0864/2000	2 point locking	Weight 700g/1.5lb							
		Universal, mixed keys							
0865/1000	3 point locking	Weight 700g/1.5lb							
		Left hand, keyed alike							
0865/2000	3 point locking	Weight 700g/1.5lb							
		Right hand, keyed alike							
0865/3000	3 point locking	Weight 700g/1.5lb							
		Left hand, mixed keys							
0865/4000	3 point locking	Weight 700g/1.5lb							
		Right hand, mixed keys							
<i>METRIC (mm)</i>		120	124	36.0	1.50	98.0	84.0	68.0	47.0
<i>IMPERIAL (ins)</i>		4.72	4.88	1.42	0.02	3.86	3.31	2.68	1.85

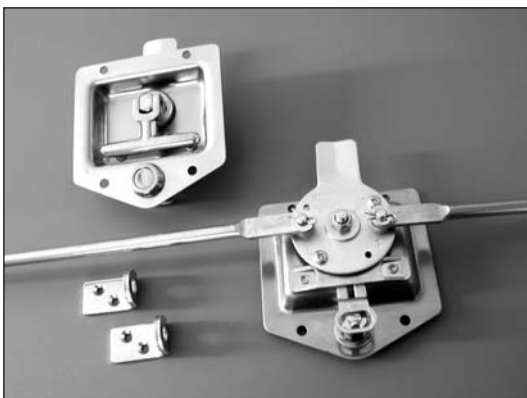

		3 WAY ROD LOCK							
		C/w recessed drop 'T' handle & zinc plated, mild steel rod & guides. Throw = 25 mm (1") Tip to tip dim. (engaged) = 2340 mm (92"). Adjustable for left or right hand operation. For recessed drop-'T' handle only see page d37.							
		A	B	C	D	E	F	G	H
5589/609	Stainless steel	Weight 1.5kg/3.3lb							
5589/611	Zinc plated								
		Locking with random keys							
5589/610	Stainless steel	Weight 1.5kg/3.3lb							
5589/612	Zinc plated								
		Locking, keyed alike							
<i>METRIC (mm)</i>		27	30	40	52	70	5.0	120	125
<i>IMPERIAL (ins)</i>		1.06	1.18	1.58	2.05	2.76	0.20	4.72	4.92