

PARTS LIST			
ITEM	QTY	PART NUMBER	DESCRIPTION
1	1	3805-BL45-1	P/C BLACK ZINC DIECAST LOCK BODY ASSEMBLY
2	1	3805-BN14-2	M/STEEL LOCK CLAMP - Z/C PASSIVATE
3	1	3805-BN14-3	M/STEEL CLAMP SCREW - Z/C PASSIVATE
4	1	3805-BN14-4	BLACK RUBBER LOCK GASKET
5	1	3805-BN14-5	ZINC LOCK STRIKER - NATURAL
6	1	3805-BN14-6	S/STEEL M6 x 25mm BOLT - NATURAL
7	1	3805-BN14-7	S/STEEL M6 HEX NUT - NATURAL

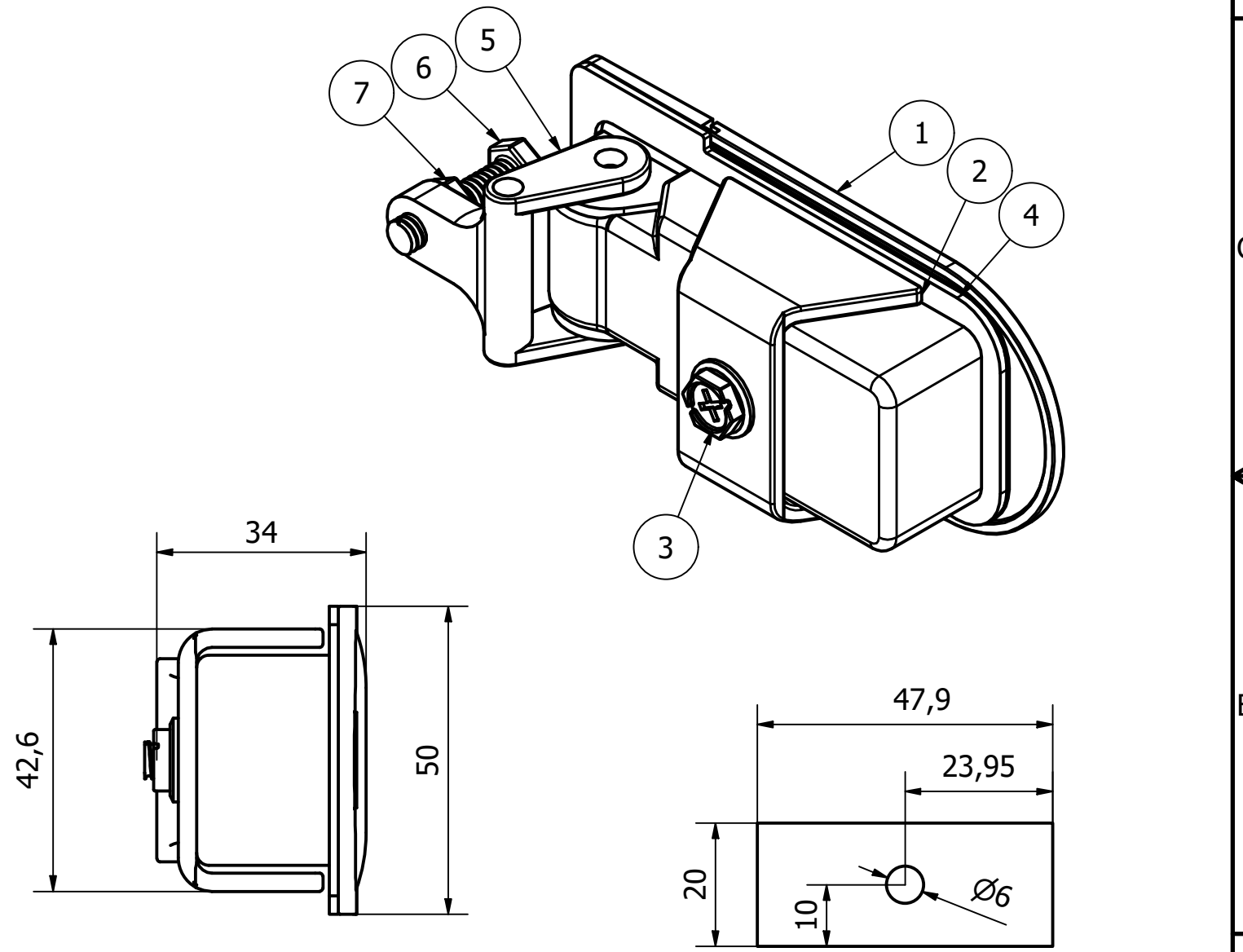

ADDITIONAL CLAMPING PLATE

NOTE:  
 LOCKABLE - SUPPLIED WITH AN ADDITIONAL CLAMPING PLATE. UTILISES A PUSH BUTTON RELEASE  
 GRIP RANGE - 1-14mm

GENERAL TOLERANCES ON LENGTHS
0.5 - 6 ± 0.1mm
6 - 30 ± 0.2mm
30 - 120 ± 0.3mm
120 - 400 ± 0.5mm
400 - 1000 ± 0.8mm
1000 - 2000 ± 1.2mm
2000 - 4000 ± 2.0mm

ALBERT JAGGER LTD  
 GREEN LANE  
 WALSALL  
 WEST MIDLANDS  
 WS2 8HG

PHONE: 01922 471000  
 FAX: 01922 648021

THIS DRAWING & THE DESIGN SHOWN ARE THE PROPERTY OF ALBERT JAGGER LTD AND MUST NOT BE USED OR COPIED BY A THIRD PARTY WITHOUT PERMISSION

DRAWN BY  
 U.F

CHECKED BY  
 A.P

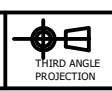

SCALE  
 1 : 1

MATERIAL  
 SEE TABLE

MASS  
 0.585 kg

FINISH  
 SEE TABLE

Date  
 05/06/2017

ALL DIMS IN MM UNLESS STATED DO NOT SCALE

A3



LOCKABLE TRIGGER LATCH C/W GASKET		Edition	Sheet
3805-BL14		2	1 / 1

2	CUTOUT DETAILS ADDED	05/04/22	U.F
1	VALIDATION COMPLETE	06/07/17	A.P
REV	DESCRIPTION	DATE	APPROVED